

NEMESIS[™]

**1.5
TONNE**

**NEMESIS
WHEEL DOLLY**



WARNING!

Read carefully and understand all ASSEMBLY AND OPERATION INSTRUCTIONS before operating.
Failure to follow the safety rules and other basic safety precautions may result in serious personal injury

General Description

The user manual is designed to assist in the safe and trouble-free use of the device. The product is designed and manufactured in accordance with strict technical guidelines, using state-of-the-art technologies and components. Additionally, it is produced in compliance with the most stringent quality standards.

<u>Parameter description</u>	<u>Parameter value</u>
Product name	Jefferson Nemesis 1.5 Tonne Wheel Dolly
Model	JEFWHLDNEM015
Dimensions	1250/1980x1000x1330/2140(mm)
Weight	119.5 (kg)
Capacity	1.5 (T)
Lifting height	0-770 (mm)

DO NOT USE THE DEVICE UNLESS YOU HAVE THOROUGHLY READ AND UNDERSTOOD THIS USER MANUAL.

To increase the product life of the device and to ensure trouble-free operation, use it in accordance with this user manual and regularly perform maintenance tasks. The technical data and specifications in this user manual are up to date. The manufacturer reserves the right to make changes associated with quality improvement. The device is designed to reduce noise emission risks to a minimum, taking into account technological progress and noise reduction opportunities.



The product satisfies the relevant safety standards.



Read instructions before use.



The product must be recycled.



WARNING or CAUTION or REMEMBER Applications to be given situation (general warning sign).



Wear foot protection.



Keep it locked.



ATTENTION! Hand crush hazard.

PLEASE NOTE! The drawings in this manual are for illustration purposes only and in some details may differ from the actual machine.

2. Usage Safety.



ATTENTION! Read all safety warnings and all instructions. Failure to follow the warnings and instructions may result in electric shock, fire and/or serious injury or even death.

REMEMBER! When using the device, protect children and other bystanders.

The terms “device” or “product” are used in the warnings and instructions to refer to ‘Nemesis 1.5 Tonne Wheel Dolly’

Safety in the workplace

- Make sure the workplace is clean and well lit. A messy or poorly lit workplace may lead to accidents.
 - Try to think ahead, observe what is going on and use common sense when working with the device.
 - If you are unsure about whether the product is operating correctly or if you find damage, please contact the manufacturer's service centre.
 - Only the manufacturer's service centre may make repairs to the product. Do not attempt to make repairs yourself!
 - Children or unauthorised persons are forbidden to enter a work station. (A distraction may result in loss of control over the device).
 - Regularly inspect the condition of the safety labels. If the labels are illegible, they must be replaced.
-
- Please keep this manual available for future reference. If this device is passed on to a third party, the manual must be passed on with it.
 - Keep packaging elements and small assembly parts in a place not available to children.
 - Keep the device away from children and animals.
 - If this device is used together with another equipment, the remaining instructions for use shall also be followed.

PERSONAL SAFETY

- Do not use the device when tired, ill or under the influence of alcohol, narcotics or medication which can significantly impair the ability to operate the device.
- The device can be handled only by physically fit persons who are capable of handling it, properly trained, familiar with this manual and trained within the scope of occupational health and safety.
- When working with the device, use common sense and stay alert. Temporary loss of concentration while using the device may lead to serious injuries.
- Use personal protective equipment as required for working with the device, specified in section 1. The use of correct and approved personal protective equipment reduces the risk of injury.
- Do not overestimate your abilities. When using the device, keep your balance and remain stable at all times. This will ensure better control over the device in unexpected situations.
- Do not wear loose clothing or jewellery. Keep hair, clothes and gloves away from moving parts. Loose clothing, jewellery or long hair may get caught in moving parts.
- The device is not a toy. Children must be supervised to ensure that they do not play with the device.
- Never stay near the device with the wheel mounted on its removal / mounting side.
- The wheel on the device must always be exactly in the vertical plane - only this will ensure stable and safe operation.
- Before moving the device with the wheel, Stop the device against sliding and use the lock to secure the wheel against uncontrolled falling out.

Safety Device Use

- Keep the device in perfect technical condition. Before each use check for general damage and especially check for cracked parts or elements and for any other conditions which may impact the safe operation of the device. If damage is discovered, hand over the device for repair before use.
- Keep the device out of the reach of children.
- Device repair or maintenance should be carried out by qualified persons, only using original spare parts. This will ensure safe use.
- To ensure the operational integrity of the device, do not remove factory-fitted guards and do not loosen any screws.
- When transporting and handling the device between the warehouse and the destination, observe the occupational health and safety principles for manual transport operations which apply in the country where the device will be used.
- Clean the device regularly to prevent stubborn grime from accumulating.
- The device is not a toy. Cleaning and maintenance may not be carried out by children without supervision by an adult person.
- It is forbidden to interfere with the structure of the device in order to change its parameters or construction.
- Keep the device away from sources of fire and heat.
- Do not overload the device.
- Only use the device on a firm, level and dirt-free surface.
- Do not allow the suspended load to drop suddenly and/or swing, especially when moving the device.
- Do not use the device if there is insufficient or no oil in the cylinder.
- Do not use the device for wheels with a diameter larger than intended by the manufacturer!

USE GUIDELINES

The product is intended for mounting and bearing car engines and facilitating work on their repairs. The user is liable for any damage resulting from unintended use of the device.

DEVICE DESCRIPTION

1. Lowering pedal
2. Lowering pedal block
3. Pumping handle
4. Supporting bar
5. Supporting arm
6. Blocking mechanism
7. Access to the hydraulic oil tank
8. Blocking spindle
9. Height adjustment block
10. Width adjustment block
11. Additional socket (for a lever)
12. Dolly handle
13. Roller supports

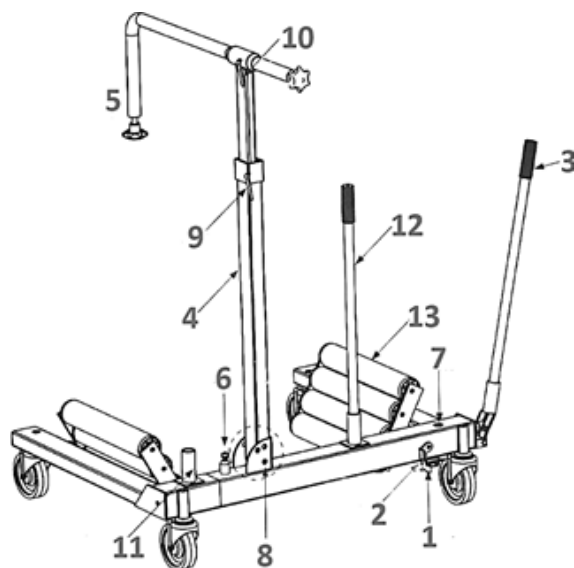

PREPARING FOR USE APPLIANCE LOCATION

The ambient temperature must not exceed 45°C and the relative humidity should not exceed 85%. Keep the device away from any hot surfaces. The device should always be used when positioned on an even, stable, clean, fireproof and dry surface, and be out of the reach of children and persons with limited mental and sensory functions.

DEVICE USE

LOADING A WHEEL ON THE DEVICE

CAUTION: The vehicle should be on an even, flat surface. The car axle from which the wheel will be removed should be lifted and rest firmly on the supports, high enough from the surface to allow the dolly to be driven under the wheel.

- Release the lowering pedal (1) with the block (2) and press it downwards. Pump the dolly up using the handle (3).
- Adjust the support bar (4) so that the support arm (5) is above the wheel.
- Slide the dolly under the wheel so that the roller supports (13) are on both sides of the wheel and the wheel itself rests against the supporting bar (4).
- Make sure that the lowering pedal (1) is in its highest position and blocked (2). Then pump up until the wheel and the device come into contact with each other.
- Lower the support arm (5) behind the wheel until it is blocked, i.e. its maximum deflection is be approx. 5cm – thanks to this, it will be possible to turn it during the assembly in order to adjust the rim holes. Block the support arm by tightening the height and width adjustment blocks (9 and 10).

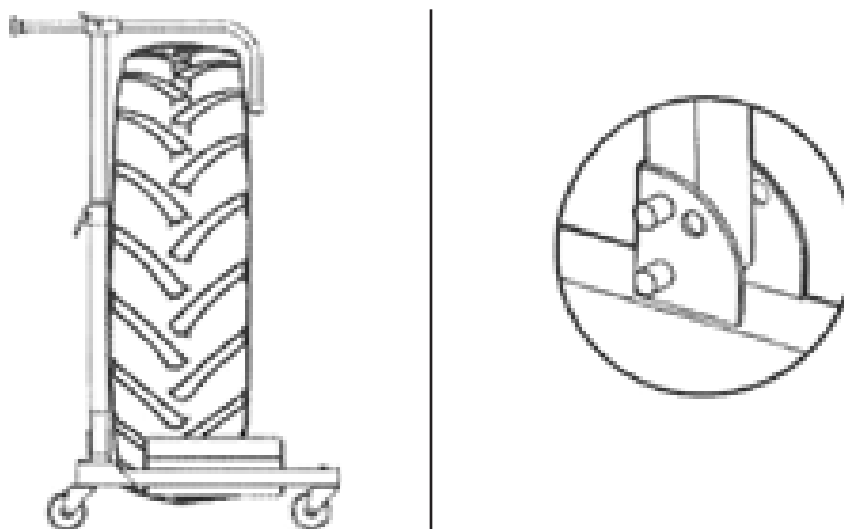

CAUTION:

It is possible to adjust the angle of the supporting bar (4) according to the type of a wheel, to do this, remove the blocking spindle (8) and set the bar (4) to the desired angle, and then block it in this position with the spindle (8).

IMPORTANT: As the name suggests – the supporting bar and the supporting arm (4 and 5) only serve to support the wheel resting on the device, not to bear its entire weight.

- Lift the wheel by pumping with the handle (3). Once the wheel rests on the device, secure it in that position using the blocking mechanism (6). **IMPORTANT:** Make sure that the device blocking mechanism (6) is inserted over the closest possible hole in the crossbar to prevent the wheel from unintentional lowering while moving the device.
- Once the wheel nuts are removed, they can be safely pulled off the hub threads.
- Place the pumping lever (3) into the additional socket and both levers can be used to safely manoeuvre the load.

UNLOADING THE WHEEL FROM THE DEVICE

After the wheel is mounted on the hub bolts and secured with nuts or transported to the storage location, the wheels can be unloaded from the device.

- Loosen the supporting arm (5) – to do this, release the adjustment blocks (9 and 10).
- Lift up and release the blocking mechanism (6)
- Release the block (2) of the lowering pedal (1) and press it. Extend the device by pumping with the handle (3).
- Set the support arm (5) so that it does not catch on the top of the wheel when driving the dolly from under it.

CLEANING AND MAINTENANCE

- Use only non-corrosive cleaners to clean the surface.
- Store the unit in a dry, cool place, free from moisture and direct exposure to sunlight.
- Do not spray the device with a water jet or submerge it in water.
- The device must be regularly inspected to check its technical efficiency and spot any damage.
- Use a soft cloth for cleaning.
- Use a soft, damp cloth for cleaning.
- Do not use sharp and/or metal objects for cleaning (e.g. a wire brush or a metal spatula) because they may damage the surface material of the appliance. Every 8 operating hours, check the oil level in the system and top up if necessary (hydraulic oil of ISO VH 15 class is recommended).

TOPPING UP HYDRAULIC OIL

Extend the device to the end position – the roller supports (13 are furthest apart. Then remove the oil tank access screw and fill it up to its limits, being careful not to spill it on the device. Refit the screw.

CAUTION: In the event of any hydraulic oil spilling, it should be immediately removed from the device and its surroundings, e.g. by using gasoline – it may disturb the proper operation of the device and may even lead to an accident!

EU Declaration of Conformity

We, Jefferson Professional Tools & Equipment, as the authorised European Community representative of the manufacturer, declare that the following equipment conforms to the requirements of the following:

**EN ISO 12100:2010, EN 17347:2021
CE Directive : 2006/42/EC (Machinery)**

Notified Body:

Ente Certificazione Macchine Srl
Via Ca' Bella, 243 – Loc.
Castello di Serravalle – 40053
Valsamoggia, ITALY

UKCA Declaration of Conformity

We, Jefferson Professional Tools & Equipment, as the authorised UK Community representative of the manufacturer, declare that the following equipment conforms to the requirements of the following:

**Supply of Machinery (Safety) Regulations 2008
SI 2008/1597, SI 2011/1043, SI 2011/2157 and SI 2019/696**

Notified Body:

Safenet Limited
Denford Garage, Denford,
Kettering, Northants,
NN14 4EQ, U.K.

Product Name / Model:

Nemesis 1.5 Tonne
Wheel Dolly
JEFWHLDNEM015

Signed by:

Stephen McIntyre



29 June 2023

Operations Manager

**Name and address of manufacturer or
authorised representative**

Jefferson Professional Tools &
Equipment
24 Lisgorgan Lane, Upperlands,
BT46 5TE

Tel: +44 (0)1244 646 048 (UK)
+353 (0)1473 0300 (ROI)
Email: info@jeffersonstools.com

NEMESIS[™]

IMPORTANT! SAFETY FIRST!

Before attempting to use this product please read all the safety precautions and operating instructions outlined in this manual to reduce the risk of fire, electric shock or personal injury.

Jefferson Tools, 24 Liscgorgan Lane, Upperlands, BT46 5TE,
Telephone: +44 (0)1244 646 048 (ROI) +353 (0)1473 0300 Email: enquiries@jeffersonstools.com
www.jeffersonstools.com