

# HEAVY DUTY

## Jefferson Heavy Duty Mobile Tool And Parts Trolley

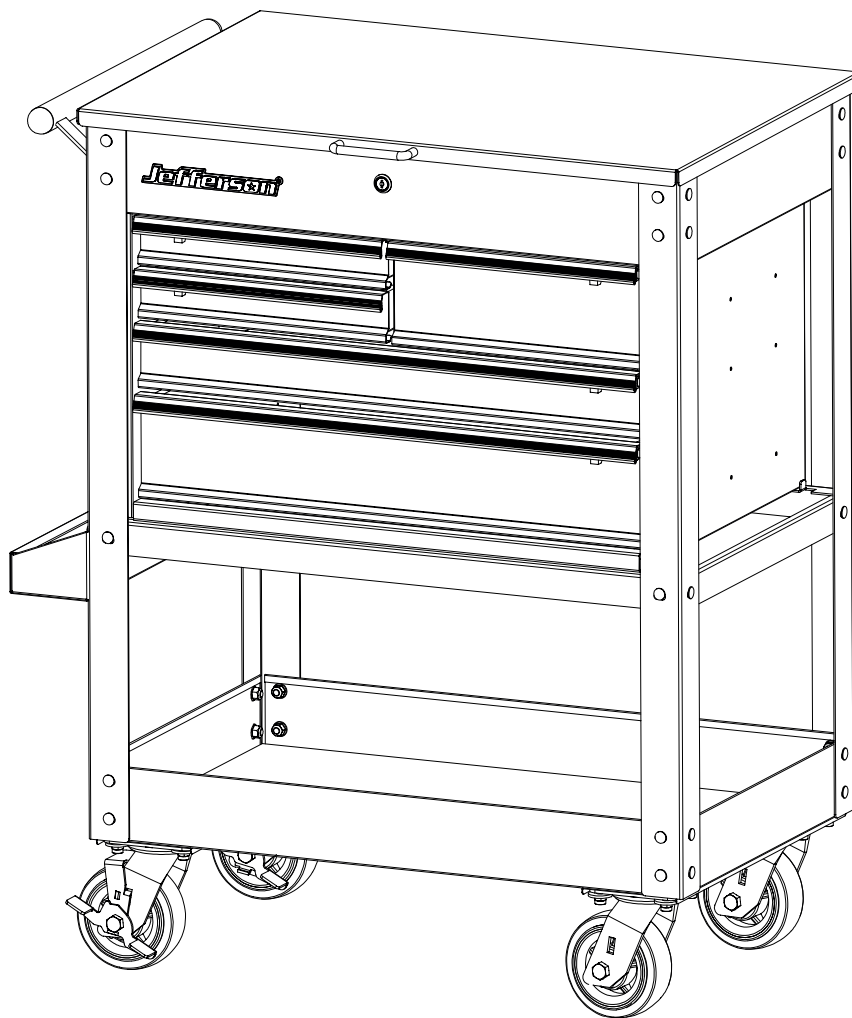

**WARNING!**

Read carefully and understand all ASSEMBLY AND OPERATION INSTRUCTIONS before operating. Failure to follow the safety rules and other basic safety precautions may result in serious personal injury.

## Owner's Manual & Safety Instructions

Keep this manual for the safety warnings and precautions, assembly, operating, inspection, maintenance and cleaning procedures. Write the product's serial number in the back of the manual near the assembly diagram (or month and year of purchase if product has no number). Keep this manual and the receipt in a safe and dry place for future reference.

### Specifications

Total Combined Weight Capacity (Evenly distributed from bottom up.) - 300KG

### IMPORTANT SAFETY INFORMATION

#### Assembly Precautions

1. Assemble only according to these instructions. Improper assembly can create hazards.
2. Wear safety goggles and heavy-duty work gloves during assembly.
3. Keep assembly area clean and well lit.
4. Keep bystanders out of the area during assembly.
5. Do not assemble when tired or when under the influence of alcohol, drugs or medication.
6. Weight capacity and other product capabilities apply to properly and completely assembled product only.
7. Assemble on a flat, level, hard and smooth surface capable of safely supporting a fully loaded Cart.

#### TO PREVENT SERIOUS INJURY AND DEATH FROM TIPPING:

1. DO NOT SIT, STAND OR CLIMB ON THIS ITEM.
2. This product is not a toy nor a toy chest. Do not allow children to play with or near this item.
3. Do not exceed 317kg weight capacity, evenly distributed from bottom up. Uneven loading causes tipping. Be aware of dynamic loading! Sudden load movement may briefly create excess load causing product failure.
4. Do not open more than one Drawer at once. Lid must be open for Drawers to be unlocked.
5. Close and lock Drawers before moving.
6. Use only on a flat, level, hard and smooth surface capable of safely supporting a fully loaded Cart. Do not roll Cart over concrete seams or other rough/uneven surfaces.
7. Do not lift using handle(s). Do not lift while loaded.
8. Lock Swivel Casters after moving.
9. Do not mount on truck bed or any other moving object.
10. Use as intended only.
11. Inspect before every use; do not use if parts are loose or damaged.
12. Maintain product labels and nameplates. These carry important safety information.

#### Assembly Instructions.

Read the ENTIRE IMPORTANT SAFETY INFORMATION section at the beginning of this document including all text under subheadings therein before set up or use of this product.

**Note:** Finger tighten hardware until assembly is complete.

1. Assemble on a flat, level, hard and smooth surface capable of safely supporting a fully loaded Cart.
2. Attach two Fixed Casters (19) to one side of the Bottom Shelf (16), using eight sets of Bolts (22a), Large Washers (22c) and Nuts (22b).
3. Attach two Locking Swivel Casters (20) to the other side, using eight sets of Bolts (22a), Large Washers (22c)
4. Attach Posts (17) to the outside corners of the Bottom Shelf, using sixteen sets of Bolts (21a)
5. Attach Front/Back Cross Supports (15) to the inside of Posts using four sets of Bolts (21a) and washer (21b) and nut (22b)
6. On the same side as Locking Swivel Casters, attach Tray (30) to the outside, and a Side Cross Support (14) to the inside of Posts using two sets of Bolts (21a) and washer (21b) and nut (22b)
7. On the other side, attach the remaining Side Cross Support to the inside of Posts using two sets of Bolts (21a) and washer (21b) and nut (22b)
8. With assistance, lift up the Chest, then lower it carefully between the Posts Front Cross Support, using two Hex Bolts (31).

**WARNING!** The Chest is heavy; do not attempt to lift and lower onto Cross Supports without assistance.

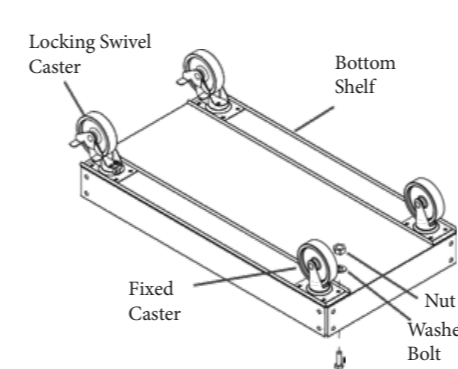

Figure A

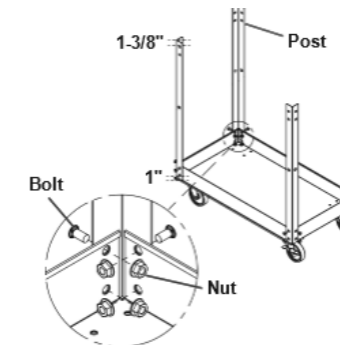

Figure B

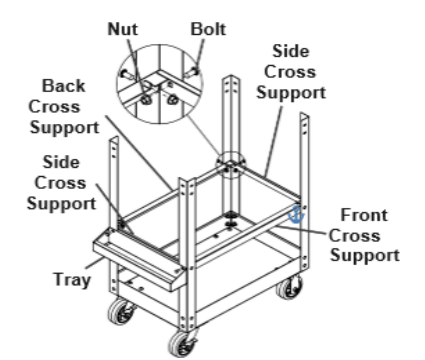

Figure C

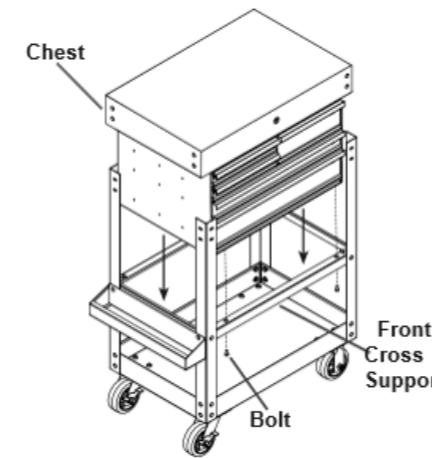

Figure D

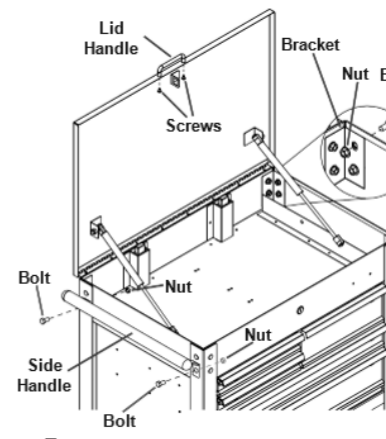

Figure E

#### Assembly Instructions Cont.

9. Attach Side Handle (18) to lower holes on same side as Locking Swivel Casters, using two sets of Bolts (22a) and washer (21b) and nut (22b)
10. Attach Lid Handle (28) using two Screws (32).
11. Place one Bracket (26) in each corner of Chest. Attach Posts to chest using fourteen sets of Bolts (21a) and washer (21b) and nut (22b)
12. Tighten all hardware, starting at the bottom.

#### Operation Instructions

Read the ENTIRE IMPORTANT SAFETY INFORMATION section at the beginning of this document including all text under subheadings therein before set up or use of this product.

1. Unlock Drawers and fill Cart evenly, from bottom to top. Do not exceed weight capacities.
2. Close all Drawers and lock them.
3. Unlock Swivel Casters.
4. Roll Cart to a flat, level, hard and smooth surface capable of safely supporting a fully loaded Cart. Do not roll Cart over concrete seams or other rough/uneven surfaces.
5. Lock Swivel Casters.

#### Maintenance and Servicing

##### **WARNING!** TO PREVENT SERIOUS INJURY FROM TOOL FAILURE:

Do not use damaged equipment. If any part becomes damaged, have the problem corrected before further use.

1. PERIODICALLY, inspect the general condition of the Cart.  
Check for:
  - Loose hardware
  - Misalignment or binding of moving parts
  - Brake operation
  - Caster swivel function and movement
  - Cracked or broken parts
  - Any other condition that may affect its safe operation.
2. Wipe external surfaces of the Cart with clean cloth.
3. Lubricate Drawer Slides as needed.

Part	Description	Qty	Part	Description	Qty
1	Lid	1	19	Fixed Caster	2
2	Lock Bar	2	20	Locking Swivel Caster	2
3a	Lock	1	21a	Bolt M8x16	38
3b	Key (not shown)	4	21b	Flange Nut M8	40
5	Drawer Handle	3	22a	Bolt M8x20	18
6	Drawer Handle	2	22b	Locknut M8	20
7	Left Drawer Latch	2	22c	Washer	16
8	Right Drawer Latch	3	23	Top Compartment Liner	1
9	Drawer Slide	10	24	Top Drawer Liner	3
10	Top Left Drawer	2	25	Middle/Bottom Drawer Liner	2
11	Top Right Drawer	1	26	Bracket	4
12	Middle Drawer	1	27	Gas Strut	2
13	Bottom Drawer	1	28	Lid Handle	1
14	Side Cross Support	2	29	Bottom Shelf Liner	1
15	Front/Back Cross Support	2	30	Tray	1
16	Bottom Shelf	1	31	Hex Bolt	2
17	Post	4	32	Screw	2
18	Side Handle	1			

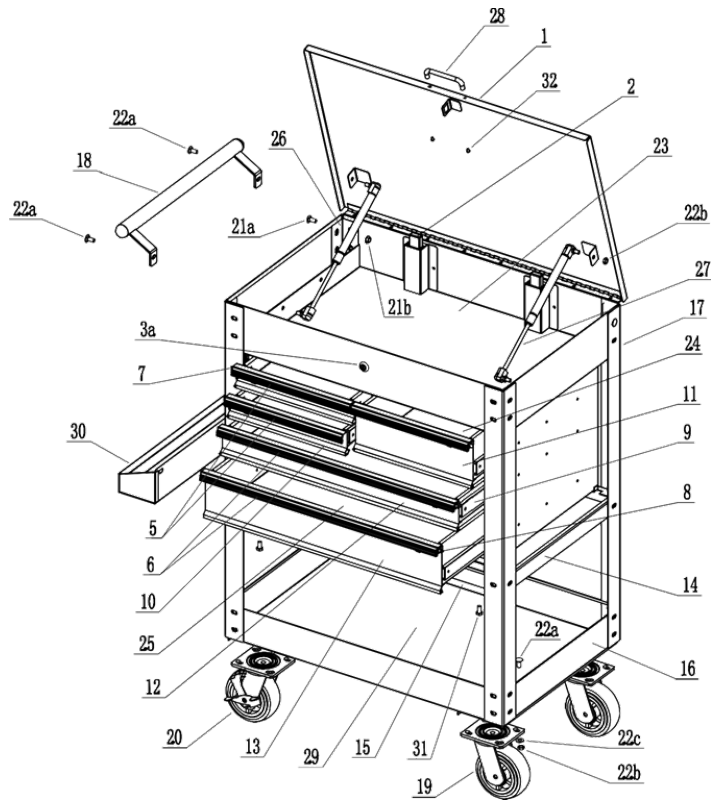

## 2 years Warranty

Jefferson Tools makes every effort to assure that its products meet high quality and durability standards, and warrants to the original purchaser that this product is free from defects in materials and workmanship for the period of 2 years from the date of purchase. This warranty does not apply to damage due directly or indirectly, to misuse, abuse, negligence or accidents, repairs or alterations outside our facilities, criminal activity, improper installation, normal wear and tear, or to lack of maintenance. We shall in no event be liable for death, injuries to persons or property, or for incidental, contingent, special or consequential damages arising from the use of our product.

THIS WARRANTY IS EXPRESSLY IN LIEU OF ALL OTHER WARRANTIES, EXPRESS OR IMPLIED, INCLUDING THE WARRANTIES OF MERCHANTABILITY AND FITNESS. To take advantage of this warranty, the product or part must be returned to us with transportation charges prepaid. Proof of purchase date and an explanation of the complaint must accompany the merchandise.

If our inspection verifies the defect, we will either repair or replace the product at our election or we may elect to refund the purchase price if we cannot readily and quickly provide you with a replacement. We will return repaired products at our expense, but if we determine there is no defect, or that the defect resulted from causes not within the scope of our warranty, then you must bear the cost of returning the product. This warranty gives you specific legal rights and you may also have other rights which vary from state to state.



Jefferson Professional Tools & Equipment  
24 Lisgorgan Lane, Upperlands, BT46 5TE

Tel: +44 (0)1244 646 048 (UK)  
+353 (0)1473 0300 (ROI)

Email: [info@jeffersonstools.com](mailto:info@jeffersonstools.com)