

EQUIPMENT OVERVIEW

- Heavy-duty adjustable steel work trestle
- Telescopic action with height-adjusting locking bars
- Dual-locking safety arms & folding support braces for rigidity when working
- Folds down for safe, compact storage
- Manufactured from tough & durable box section steel

SPECIFICATIONS

Model Number:	JEFTRESTEL
Open Dimensions: (LxW):	680 x 580mm
Height:	800-1300mm
Folded Width:	135mm
Max load:	150kg
Net Weight:	6.2kg

SAFETY

The following safety guidelines will help to ensure safe use of this equipment:

1. When assembling ensure all parts are attached securely to the legs. Hand tighten all screws and bolts until stable, then put the trestle upright and fasten with a spanner or wrench until secure.
2. This product is not designed to be used as a ladder or platform. Do not stand, step or sit on the crossbar or any work piece.
3. Do not exceed the recommended maximum load capacity (**150kg**). Always lower heavy loads onto work tops slowly so that the load is gradually increased.
4. Always use the trestle on a firm, level surface.
5. Before each use always check that all fastenings are tight. Tighten with a spanner as necessary to secure.
6. Keep children and pets away from the multi purpose support at all times.
7. If two trestles are used to make a work surface, always put the panel or board in the centre of each multi purpose support to ensure an equal division of the load.
8. Loads should not be placed on the extremities or the protruding side.
9. Check equipment and fittings for any damage prior to use. Never use this equipment if damage is detected.

OPERATION

Setting Up The Trestle:

1. Fold out the support legs completely and lower the spreader bars completely (until they are completely horizontal).
2. Lower the safety catch completely and engage with the cap screw to secure (See Fig.1).

Height Adjustment:

1. Remove the locking pins for the height adjustment and raise (or lower) the support rail to the desired height.
2. Insert the locking pins again. (See Fig.2a).
3. Fold up the two side stops on the carrier rail on both sides. (See Fig.2b).

Setting Up The Working Surface:

Position one side of a scaffolding plank or a similar stable plate suitable for the required load in the area between the side stops and the other side on a second support frame or another stable surface. Before starting work, always check and make sure that the work surface (eg. scaffolding plank) is stable and level.

Maintenance:

Keep the trestle clean, free from grease and grime. Store in a dry environment.



Fig.1 Setting up the trestle

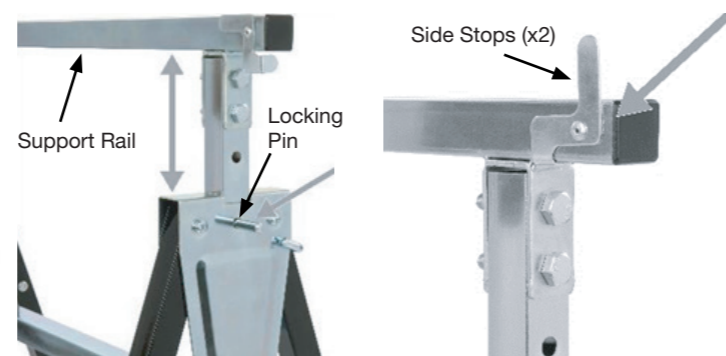
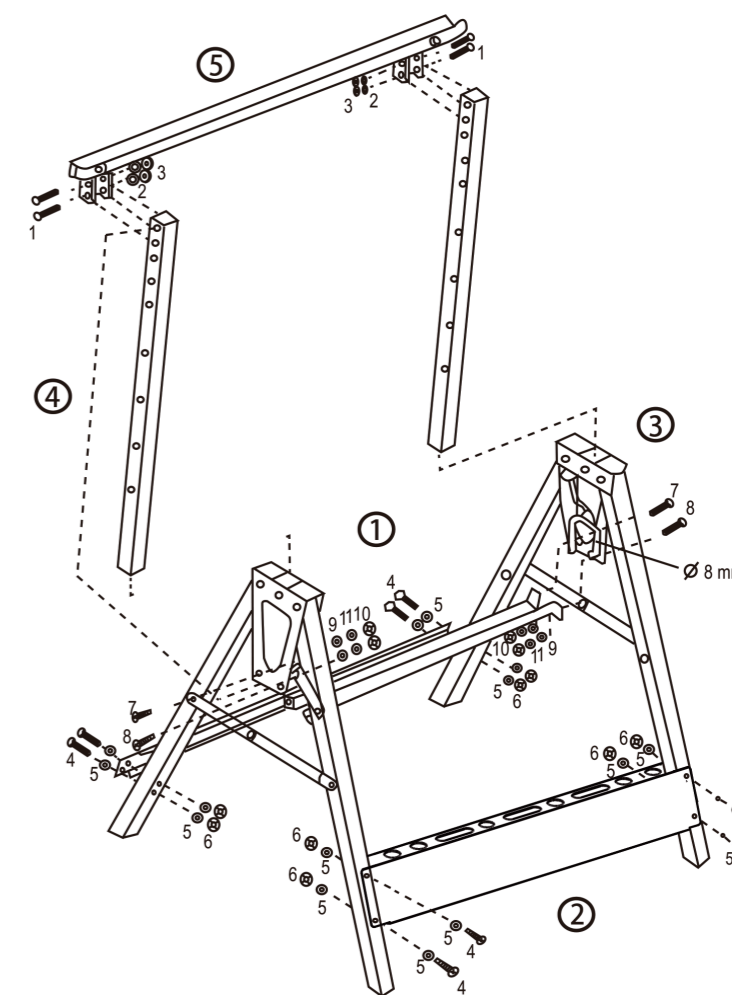

Fig.2a Height adjustment

Fig.2b Height adjustment

ASSEMBLY INSTRUCTIONS

#	Part	Description	Qty
1		Hexagonal Bolt (#1) Ø8 x 45mm	4
2		Internal Washer Ø8.4mm For Hexagonal Bolt (#1)	4
3		Hexagonal nut Ø8mm For Hexagonal Bolt (#1)	4
4		Round Head Bolt (#4) Ø6mm x 35mm	8
5		Internal Washer Ø6.4mm For Round Bolt (#4)	16
6		Hexagonal Nut Ø6mm For Round Bolt (#4)	8
7		Flat Head Bolt (#7) Ø5mm x 15mm	2
8		Hexagonal Bolt (#8) Ø5mm x 15mm	2
9		Internal Washer Ø5.3mm For Bolts #7 & #8	4
10		Hexagonal nut Ø5mm For Bolts #7 & #8	4
11		Internal Spring Washer Ø5.3mm For Bolts #7 & #8	4



WARRANTY

Jefferson Professional Tools & Equipment, or hereafter "Jefferson" warrants its customers that its products will be free of defects in workmanship or material. Jefferson shall, upon suitable notification, correct any defects, by repair or replacement, of any parts or components of this product that are determined by Jefferson to be faulty or defective.

This warranty is void if the equipment has been subjected to improper installation, storage, alteration, abnormal operations, improper care, service or repair.

Unless otherwise stated, the guarantee is 12 months from purchase date, proof of which is required for any claim. Full details of how you can register and activate your warranty as well as instructions on how to make a warranty claim are available on our website: warranty@jeffersonstools.com. For any further information relating to Jefferson warranty cover please call +44 (0)1244 646 048 (UK) or +353 (0)1473 0300 (ROI).

Jefferson Professional Tools & Equipment
24 Lisgorgan Lane, Upperlands, BT46 5TE,

Tel: +44 (0)1244 646 048 (UK)
+353 (0)1473 0300 (ROI)
Email: info@jeffersonstools.com