

46" 5 DRAWER PROFESSIONAL WORKSTATION

JEFTB46-5WS



WARNING!

Read carefully and understand all ASSEMBLY AND OPERATION INSTRUCTIONS before operating.
Failure to follow the safety rules and other basic safety precautions may result in serious personal injury

Important Safety Information:

- Assemble only according to these instructions. Improper assembly can create hazards.
- Wear Safety goggles and heavy-duty work gloves during assembly.
- Keep assembly area clean and well lit.
- Keep bystanders out of the area during assembly.
- Do not assemble when tired or when under the influence of alcohol, drugs or medication.
- Weight capacity and other product capabilities apply to properly and completely assembled product only.
- Total weight capacity : 544kg. Shelf Capacity: 45kg. Drawer Capacity: 45kg
- Assemble on a flat, level, hard and smooth surface capable of safely supporting loaded Cabinet.

TO PREVENT SERIOUS INJURY AND DEATH FROM TIPPING:

- DO NOT OPEN more than one drawer at once. This cabinet cannot prevent multiple drawers from opening.
- LOAD FROM BOTTOM UP ONLY.
- DO NOT SIT, STAND OR CLIMB ON THIS ITEM.
- This product is not a toy nor a toy chest. Do not allow children to play with or near this item.
- Do not use for food preparation.
- Do not exceed weight capacities, evenly distributed from bottom up. Be aware of dynamic loading! Sudden load movement may briefly create excess load causing product failure.
- Empty, close, and lock Drawers before moving.
- Use only on a flat, level, hard and smooth surface capable of safely supporting a fully loaded Cabinet. Do not roll Cabinet over concrete seams or other rough/uneven surfaces.
- Do not lift using handle(s). Do not move or lift while loaded.
- Lock Swivel Casters after moving.
- Do not mount on truck bed or any other moving object.
- Use as intended only.
- Inspect before every use; Do not use if parts are loose or damaged.
- Maintain product labels and nameplates. These carry important safety information.

Assembly Instructions:

1. Assemble on a flat, level, hard and smooth surface capable of safely supporting a fully loaded Cabinet
2. Attach Side Handle (3) to either side of Cabinet using four Handle Bolts (4).
3. Attach two Locking Swivel Casters (6) to the same side as Handle using eight Flat Washers (7), eight Spring Washers (8), and eight Bolts (9).
4. Attach two Fixed Casters (5) to the other side using eight Flat Washers (7), eight Spring Washers (8), and eight Bolts (9).
5. Lock the Swivel Casters by depressing the brake levers.

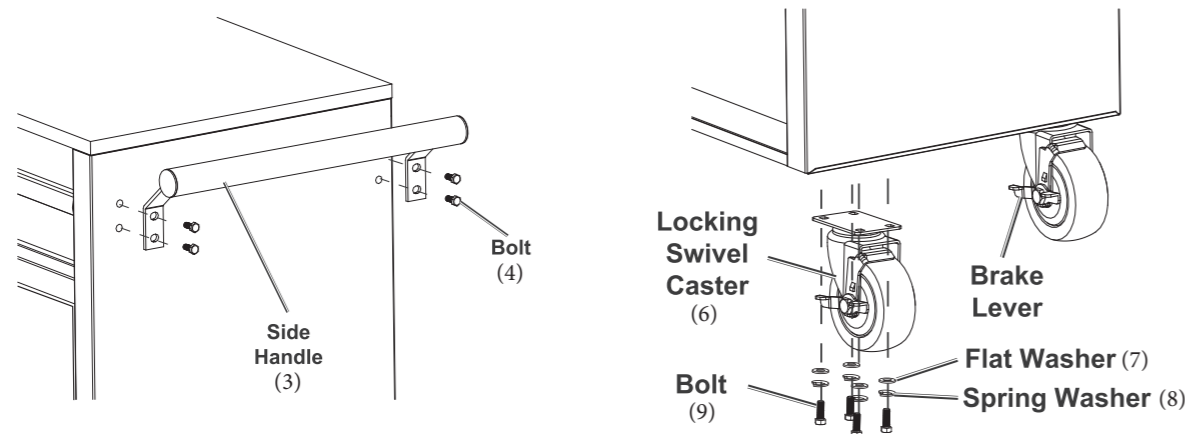

Operation Instructions

1. Empty all Drawers.
2. Close all Drawers and lock them.
3. Unlock Swivel Casters.
4. Roll Cabinet to a flat, level, hard and smooth surface capable of safely supporting a fully loaded Cabinet. Do not roll Cabinet over concrete seams or other rough/uneven surfaces.
5. Lock Swivel Casters.
6. Unlock Drawers and fill Cabinet evenly, from bottom to top. Do not exceed weight capacities

Maintenance and Servicing:



Procedures not specifically explained in this manual must be performed only by a qualified technician.

WARNING! TO PREVENT SERIOUS INJURY FROM TOOL FAILURE. Do not use damaged equipment. If any part becomes damaged, have the problem corrected before further use.

1. PERIODICALLY, inspect the general condition of the Cabinet.

- Check for:
- Loose hardware,
 - Misalignment or binding of moving parts,
 - Brake operation,
 - Caster swivel function and movement,
 - Cracked or broken parts,
 - Any other condition that may affect its safe operation.

2. Wipe external surfaces of the Cabinet with clean cloth.
3. Lubricate Drawer Slides as needed.

Parts List

Part	Description	Qty
1	Wood Top	1
2	Cabinet	1
3	Handle	1
4	Handle Bolt	4
5	Fixed Caster	2
6	Swivel Caster	2
7	Flat Washer	16
8	Spring Washer	16

Part	Description	Qty
9	Caster Bolt	16
10	Drawer A	1
11	Drawer B	2
12	Drawer C	1
13	Drawer D	1
14	Shelf	1
15	Door	1

Assembly Diagram

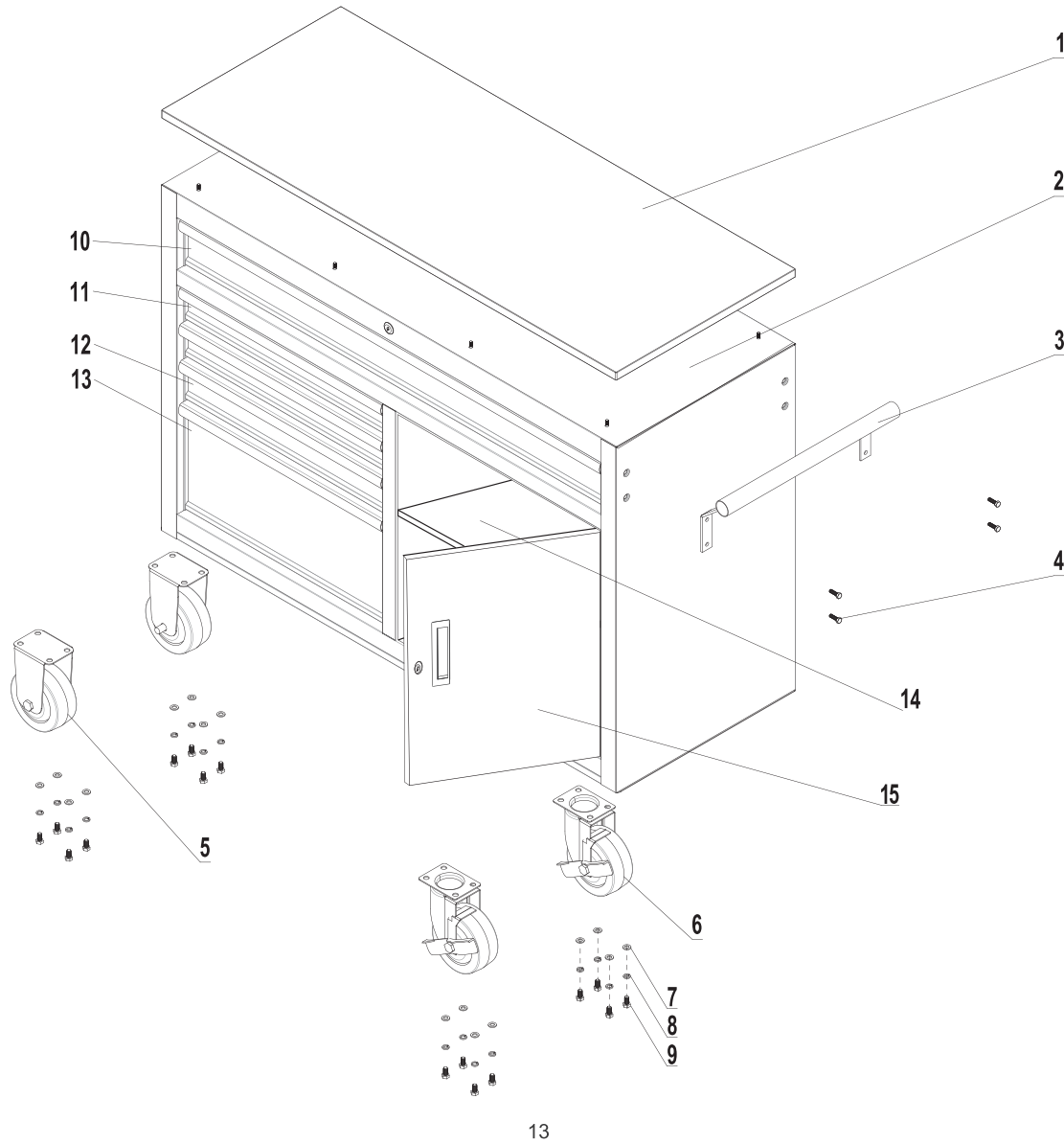

Jefferson[®]
PROFESSIONAL TOOLS & EQUIPMENT

Jefferson Professional Tools & Equipment
24 Lisgorgan Lane, Uppertlands, BT46 5TE

Tel: +44 (0)1244 646 048 (UK)
+353 (0)1473 0300 (ROI)

Email: info@jeffersonstools.com