

PRESSURE WASHER 170BAR

JEFPRWEL170



SAVE THESE INSTRUCTIONS

Please read and comply with these original instructions prior to the initial operation of your appliance and store them for later use or subsequent owners. Apart from the notes contained herein the general safety provisions and rules for the prevention of accidents of the legislator must be observed.

Warnings and notes that are attached on the appliance provide important notes for the safe operation.

Description Of Appliance

1. Handle
2. Adjust switch OFF/ON
3. Power cord
4. Front case
5. Power cord hook
6. Adjust detergent switch
7. Wheel
8. Water inlet
9. High-pressure hose hook
10. Trigger gun
11. High-pressure hose
12. Nozzle
13. Trigger gun holder
14. Detergent tank holder
15. Spray wand
16. Detergent tank
17. Rear case
18. Water Outlet
19. Spray wand protector

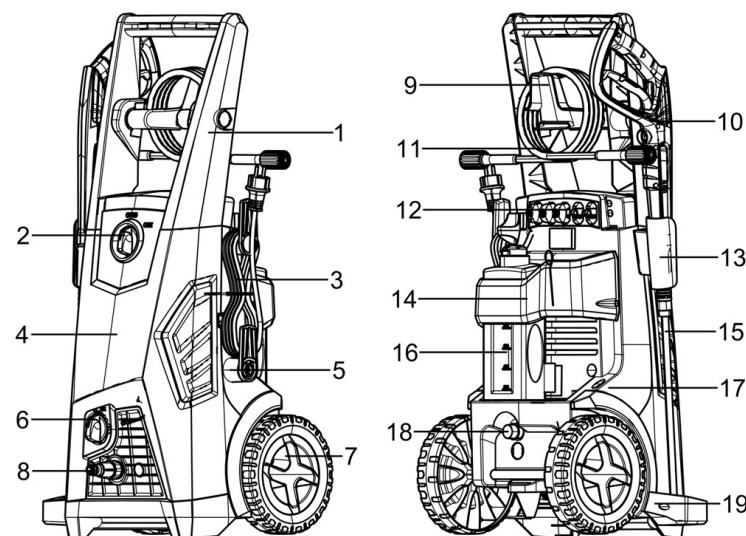

Specification

Voltage: 220-240V ~
Frequency: 50Hz
Watt: 3000W
Protection Class I
Degree of protection: IPX5
Rated pressure: 14MPa
Allowable pressure: 18MPa
Rated flow: 8.7L/min
Max. Flow : 9.2L/min

Max. Inlet pressure: 0.7MPa
Sound pressure level:
Uncertainty: LpA=86dB(A)
KpA=3dB
Guarantee Sound power level:
Uncertainty: LwA=96dB(A)
LwA=3dB
Vibration value: ah=5.36m/s2
Kah=1.5m/s2
Weight: 23Kg

Assembly

1. Installing the handle and nozzle holder into position of unit with screws.
2. Slide the trigger gun holder into position of unit right
3. Installing the spray wand protector

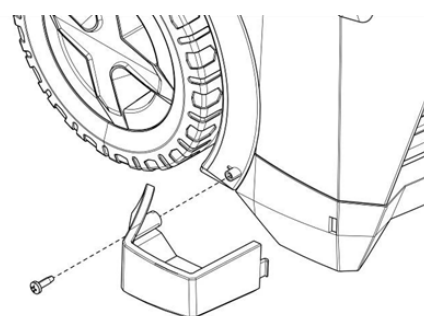
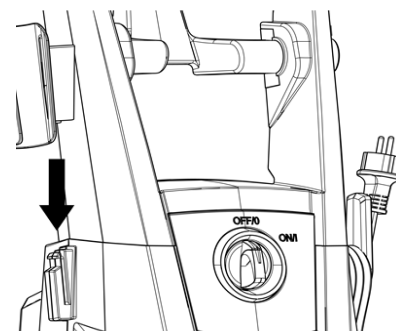
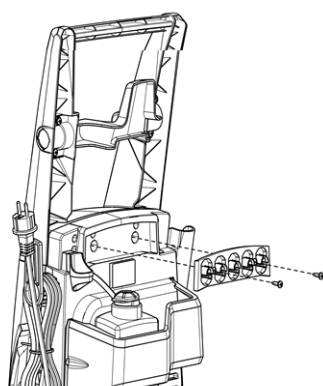

4. Installing the spray wand
Fit the spray wand into the gun and rotate it until the two parts are completely locked

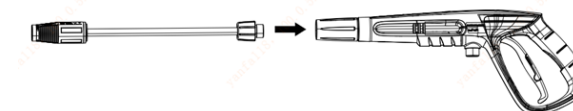

5. Connect the high-pressure hose to the water outlet
Insert high pressure hose into opening, as shown until it clicks securely in place

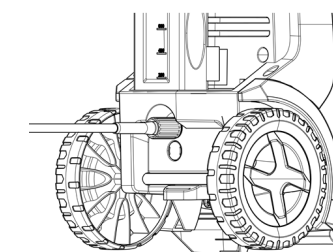

6. Connect the garden hose to the water inlet
Connect the garden hose adaptor(female coupler) to the water inlet of the pressure washer, then thread your garden hose (male end) into the garden hose adaptor.

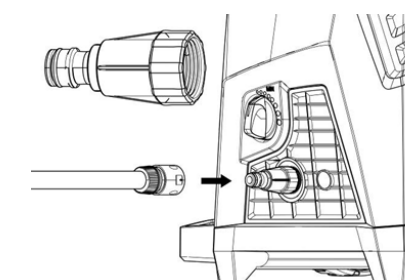

Start Up.

Park the appliance on an even surface. Insert the mains plug into the socket.

ATTENTION

Impurities in the water can damage the high-pressure pump and the accessories.
Water supply from mains

Drawing in water from the open reservoirs

This high-pressure cleaner is suited to work with the Jefferson suction hose with backflow valve to draw in surface water, e.g. from water butts or ponds.

Fill the suction hose with water.

Screw the suction hose into the water connection of the appliance and insert it into the water source (e.g. rainwater drum).

Bleed the device as follows prior to operation:

- Turn on the appliance "OFF/ON" switch.
- Unlock the lever of the trigger gun.
- Push the lever of the trigger gun, the device will switch on.
- Let the device run (max. 2 minutes) until the water exits the trigger gun without bubbles.
- Release the lever of the trigger gun.
- Lock the lever of the trigger gun.

Operation

ATTENTION

Dry running of more than 2 minutes leads to damage of the high-pressure pump. If the appliance does not build up pressure within 2 minutes, switch the appliance off and proceed in accordance with the instructions in Chapter “Troubleshooting”

High pressure operation

CAUTION

Keep a distance of at least 30 cm when using the jet for cleaning painted surfaces to avoid damage.

CAUTION

Make sure the on/off switch is set to “OFF/ON” position and insert the plug into a properly installed socket.

ATTENTION

- The washer must be used on a secure and stable surface in a standing, upright position

Connect the product to power and water supply as described.

- Open the water supply
- Hold the spray gun with both hands.
- Direct the nozzle of the chosen accessory away from you towards the surface to be cleaned.
- Turn on the switch “OFF/ON”.

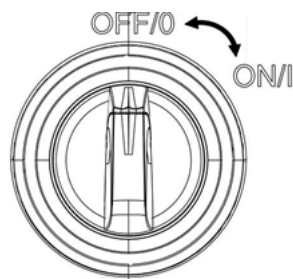

- Unlock the trigger and press it until a constant amount of water flows through the nozzle, to allow air trapped in the hose to escape.
- Hold the spray gun with both hands. Direct the water jet to the object to be cleaned and press the trigger. Release the lever of the trigger gun; the device will switch off again and stop the water jet. High pressure remains in the system.

WARNING! Beware of kickback when pressing the trigger!

Operation with detergent

Detergent can only be added when the device is operated in low pressure mode.

DANGER

When using detergents, the material data safety sheet issued by the detergent manufacturer must be adhered to, especially the instructions regarding personal protective equipment.

Remove the cap of the clean detergent tank. Gently pull the detergent tank out of its storage position.

Fill the tank with detergent designed specifically for use with pressure washers, then put the detergent tank with detergent back.

Install the soap nozzle (black) on the spray wand.

Recommended cleaning method

- Turn on the pressure washer, then pull the trigger to operate the unit. The liquid detergent will automatically mix with water and be discharged through the nozzle.
- Turn the detergent dial to adjust the suction volume of the detergent solution
- Spray the detergent sparingly on the dry surface and allow it to react, but not to dry.
- Spray off loosened dirt with the high pressure mist

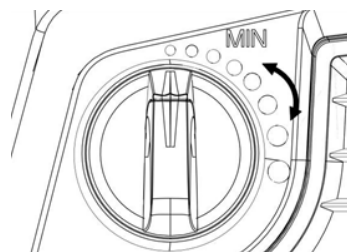

After operation with detergent

- When finished using the pressure washer, you must first drain remaining detergent, then rinse the detergent tanks with clean water.
- Run the pressure washer in high pressure until the remaining detergent is cleaned out from the system. Jefferson are not responsible for the damage caused by detergent or any chemical agent.
- For storage, put the detergent tank into the position with the cap.

Interrupting operation

- Release the lever of the trigger gun.
- Lock the lever of the trigger gun.
- Put the trigger gun with the spray lance into the parking position.
- During longer breaks (more than 5 minutes), also turn the appliance off using the “OFF/ON” switch.

Finish operation

- Release the lever of the trigger gun.
- Shut off water supply.
- Turn off the appliance " OFF/ON" switch.
- Disconnect the mains plug from the socket.
- Pressure the lever of the trigger gun to release any remaining pressure in the system.
- Release the lever of the trigger gun.
- Lock the lever of the trigger gun.

ATTENTION

- When disconnecting the supply or high pressure hose, warm water may leak from the connection after operation.
- Detach the appliance from the water supply.

Transport

CAUTION - Risk of personal injury or damage!

Mind the weight of the appliance during transport.

When transporting by hand

- Switch the product off and disconnect it from the water and power supply.
- Pull out the transport handle until it snaps into place. Attach transportation guards, if applicable.
- Pull the appliance by its transport handle.

When transporting in vehicles

- Prior to horizontal transport: close the cap of clean detergent bottle.
- Tilt the product towards you until it balances on the wheels. Then move it by its transportation handle.
- Protect the product from any heavy impact or strong vibrations which may occur during transportation in vehicles.
- Secure the appliance against shifting and tipping over.

Storage

CAUTION - Risk of personal injury or damage!

Consider the weight of the appliance when storing it.

Storing the appliance

- Park the machine on an even surface.
- Detach spray wand from the trigger gun.
- Push the disconnect button on the trigger gun and pull the high-pressure hose out of the trigger gun.
- Place the trigger gun into the storage for the trigger gun.
- Reel the high pressure hose on reel.
- Store the mains connection in the accessory compartment.
- Prior to extended storage periods, as during the winter, also observe the instructions in the care section.
- Always store the pressure cleaner, parts, and accessories in a place that is inaccessible to children. The ideal storage temperature is between 10 °C and 30 °C. Store the power washer indoors to prevent the water in the unit from expanding under freezing conditions.
- We recommend using the original package for storage or covering the product with a suitable cloth or enclosure to protect it against dust.

Frost protection

ATTENTION

Appliance and accessories that are not completely drained can be destroyed by frost.

Completely drain appliance and accessories and protect them against frost. To avoid damage:

- Detach the appliance from the water supply.
- Detach nozzle from the spray wand.
- Turn on the appliance “ON/OFF” switch.
- Push the lever of the trigger gun until no more water is escaping .
- Release the lever of the trigger gun.
- Lock the lever of the trigger gun.
- Turn off the appliance “ON/OFF” switch.
- Store the appliance and the entire accessories indoors.

Care and Maintenance

DANGER

Risk of electric shock

Prior to all work on the appliance, switch off the appliance and pull the power plug.

High pressure hose

The high pressure hose is specially constructed with reinforced walls it can be easily damaged and should be stored carefully.

- Do not kink.
- Do not drive vehicles over the hose.
- Do not expose the hose to sharp edges or corners. Misuse will lead to ballooning or premature failure and will invalidate warranty.

Clean the filter in the water connection

Clean the filter in the water connection regularly.

Remove coupling from the water connection, and rinse with warm water to prevent any foreign matter from clogging the pump.

Clean the nozzle with the needle clean-out tool provided. Remove the spray wand from the gun. Remove any dirt from the nozzle hole and rinse.

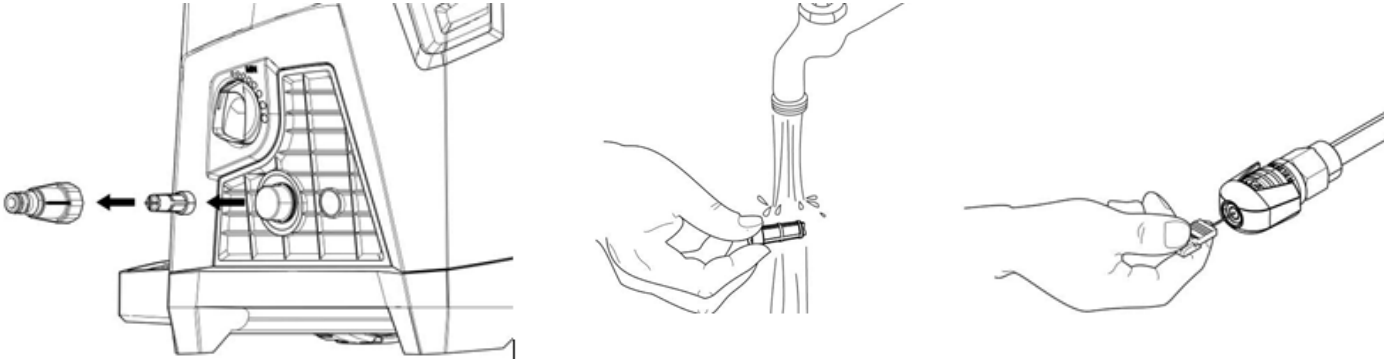

ATTENTION

- The s filter must not be damaged.
- Pull the filter out using flat pliers.
- Clean the filter under running water.
- Reinsert the filter into the water connection.

Troubleshooting

DANGER Risk of electric shock.

Turn off the appliance and remove the main plug prior to performing any care and maintenance work. Repair work and work on the electrical

components should be performed by an authorized customer service. You can rectify minor faults yourself with the help of the following overview.

If in doubt, please consult the authorized customer service.

Symptom	Cause	Recommended Action
Machine refuses to start	Machine not plugged in. Defective socket. Fuse has blown. Defective extension cord	Plug in machine. Try another socket. Replace fuse. Switch off other machines. Try without the extension cord.
Fluctuating pressure	Pump sucking air. Valves dirty, worn out or stuck. Pump seals worn out.	Check that hoses and connections are airtight. Clean and replace or refer to local distributor
Machine stops	Incorrect mains voltage. Thermal sensor activated. Nozzle partially blocked	Check that the mains voltage corresponds to specification on the model tag. Leave the washer for 5 minutes to cool down. Clean the nozzle
Machine starts, but no water comes out	Pump/hoses or accessory frozen No water supply Water filter blocked /Nozzle blocked	Wait for pump/hoses or accessory to thaw. Connect inlet water. Clean the filter / Clean the nozzle

Safety - Electric Components

DANGER!

Risk of electric shock.

Never touch the mains plug and the socket with wet hands.

Check the power cord with mains Plug for damage prior to every use. Do not use the machine if a supply cord or important parts of the machine are damaged, e.g. safety devices, high pressure hoses, trigger gun.

All current-conducting parts in the working area must be protected against jet water.

The mains plug and the coupling of an extension cable must be watertight and must never lie in water. The coupling may never lie on the ground.

The use of cable reels that ensure that the sockets are at least 60 mm above the ground is commended.

Make sure that the power cord or extension cable is not damaged by running over, pinching, dragging or the like. Protect the power cords from heat, oil, and sharp edges.

Always switch off the mains when leaving the appliance unattended.

WARNING

The appliance may only be connected to an electric supply that has been installed by an electrician in accordance with IEC 60364.

The appliance may only be connected to alternate current. The voltage must correspond with the type plate of the appliance.

For safety reasons, we recommend that you operate the appliance only via a residual current device (max. 30mA).

An unsuitable electrical extension cable can be hazardous. Only use an electrical extension cable which has been approved and labelled for this purpose and has an adequate cable cross-section outdoors: 1 - 10m: 1.5 mm2;10 - 30 m: 2.5 mm2

Always fully unreel the extension cable from the cable drum.

Safe Handling

DANGER!

The user must use the appliance as intended. The person must consider the local conditions and must pay attention to other persons in the vicinity when working with the appliance.
Check important components, such as high pressure hose, hand spray gun and safety installations, for damage prior to every operation. Immediately replace damaged components. Do not operate appliance with damaged components.
High-pressure jets can be dangerous if subject to misuse. The jet must not be directed at persons, live electrical equipment or the machine itself. Do not direct the jet against yourself or others in order to clean clothes or footwear.
Do not use the appliance within range of persons unless they wear protective clothing.
Wear appropriate Personnel Protection Equipment (PPE) while operating the appliance.

WARNING

The appliance must not be operated by children or untrained personnel.
This appliance is not intended for use by persons(including children) with reduced physical, sensory or mental capacities, or lacking experience and knowledge.
Children must not play with this appliance.
Supervise children to prevent them from playing with the appliance.
Create stability for the appliance prior to any work on or with the appliance to prevent accidents damage.
The water jet that is emitted from the high pressure nozzle results in a repulsion power acting on the hand spray gun. Make sure that you have a firm footing and are also holding the hand spray gun and spray lance firmly.
Never leave the appliance unattended as long as it is in operation.

ATTENTION

In case of extended breaks, switch the appliance off at the main switch or pull the mains plug.
Do not operate the appliance at temperatures below 0°C

Other Risks

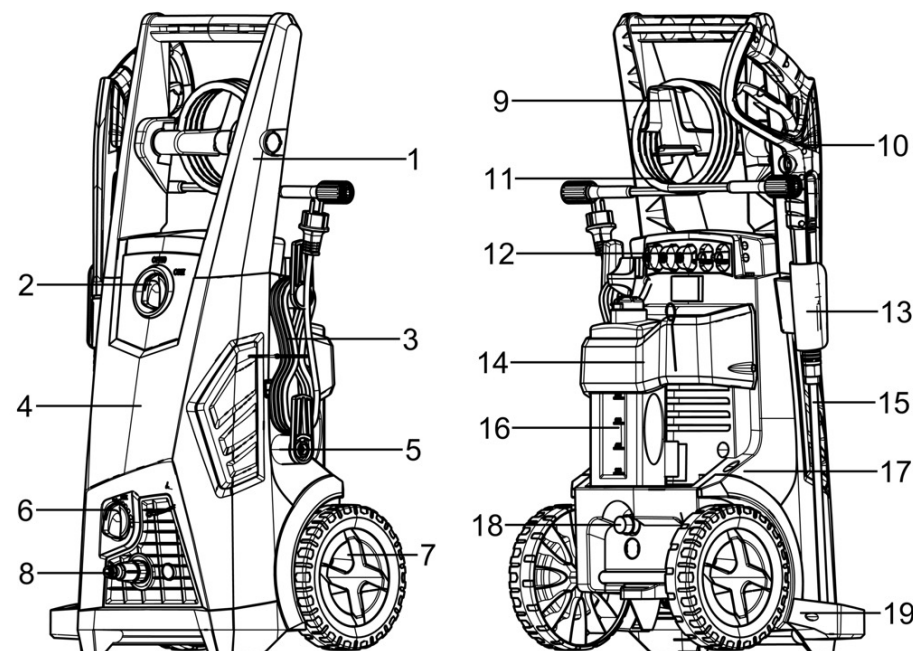

Working with detergent - WARNING

The improper use of detergents can cause severe injuries or oxidation.
Store cleaning agent away from the reach of children.
Discharge residual pressure before disconnecting the hose from the product.
Check before each use , and at regular intervals, that all metal fasteners are tight and the product's components are in good condition; inspect for broken or worn parts.
Be aware of kick-back: Hold With Both Hands.

SERVICING OF A DOUBLE-INSULATED APPLIANCE

In a double-insulated product, two systems of insulation are provided instead of grounding. Grounding means are not provided for a double - insulated product, nor should grounding means be added to the product. Servicing a double-insulated product requires extreme care and knowledge of the system, and should only be done by qualified service personnel. Replacement parts for a double-insulated product must be identical to the original parts. A double-insulated product is marked with the words "Double Insulation" or "Double Insulated".

Residual risks

Even if you are operating this product in accordance with all the safety requirements, potential risks of injury and damage remain.
The following dangers can arise in connection with the structure and design of this product:
Health defects resulting from vibration emission if the product is being used over long periods of time or not adequately managed and properly maintained.
Danger of injury and property damage caused by flying objects.
Injuries and damage to property due to broken accessories or the sudden impact of hidden objects during use.

Safety Devices - CAUTION

Safety installations serve the protection of the user and may not be modified.
Power switch: The appliance switch prevents unintentional operation of the appliance.
Lock trigger gun : This lock locks the lever of the trigger gun and prevents the inadvertent start of the appliance.
Overflow valve with Water that has flowed through backflow preventers is considered to be non-potable.
Pressure switch: If the lever on the trigger gun is released the pressure switch turns off the pump, the high pressure jet is stopped. If the lever is pulled the pump is turned on again.
Motor protection switch: The motor protection switch off the device if the power consumption is high.

Personal protective equipment - CAUTION

Wear protective clothing and safety goggles to protect against splash back containing water or dirt.
During the use of high-pressure cleaners aerosols can develop. Inhaling aerosols can cause health damage.
Depending on the application, completely shielded nozzles (e.g. surface cleaner) that significantly reduce the emission of aqueous aerosols can be used for high-pressure cleaning. The use of such shielding is not possible with all applications.

Symbols on the machine.



The high pressure jet must not be directed at persons, animals, live electrical equipment or at the appliance itself.



The appliance must not be directly connected to the public drinking water network



Sound power level is 86dB(A)

Accessories

A choice of accessories is supplied in the scope of the delivery of this product. Please check the technical specification of any accessories that you purchase to ensure they are compatible with this product.

Warranty

1. This product has been manufactured to a high quality standard. The warranty period is 3 months from date of purchasing.
2. For warranty service, please contact the present the warranty card and the original invoice for the warranty service.
3. This warranty DOES NOT applies to: O-rings, seals, valves, nozzles, filters, damages to high pressure hose, gun, pump, motor, housing shells due to misuse, operation errors, or exposure to natural elements.
4. Transportation damages after sales.
5. Services not provided by our authorized service centers.
6. Accessories and spare parts, if any, provided in the package.
7. Damage resulted from commercial or industrial use, as this product is intended for DIY use only.



EC Declaration of Conformity

We, Jefferson Professional Tools & Equipment, as the authorised European Community representative of the manufacturer, declare that the following equipment conforms to the requirements of the following:



Machinery Directives 2006/42/EC	EN60335-1:2013+A11:2014+A13:2017+A1:2016+A14:2016+A2:2019 EN60335-2-79:2012 EN62233:2008	
EMC Directives 2014/20/EU	EN IEC 55014-1:2021 EN61000-3-2:2019+A1:2021	EN IEC 55014-2:2021 EN61000-3-2:2013+A1:2019
RoHS Directives 2011/65/EU	EU 2015/863	

Notified Testing Body: Eurofins Product Testing Service Blding
18, 2168 Chenhang Highway, Minhang
District, Shanghai. China

Description:	Jefferson 170Bar Pressure Washer JEFPRWEL170
Signed:	Stephen McIntyre Operations Manager 
Date:	23rd November 2023
Name and address of manufacturer or authorised representative:	Jefferson Professional Tools & Equipment 24 Lisgorgan Lane, Upperlands, BT46 5TE Tel: +44 (0)1244 646 048 (UK) +353 (0)1473 0300 (ROI) Email: info@jeffersonstools.com



Jefferson®
PROFESSIONAL TOOLS & EQUIPMENT

Jefferson Professional Tools & Equipment
24 Lisgorgan Lane, Upperlands, BT46 5TE

Tel: +44 (0)1244 646 048 (UK)
+353 (0)1473 0300 (ROI)

Email: info@jeffersonstools.com